

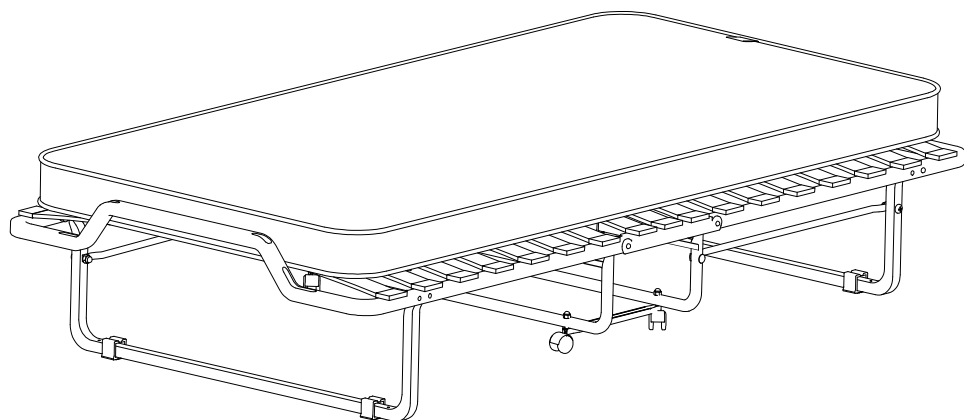

4051419UK Luxury Folding Guest Bed with Memory Foam Mattress

Weight Limit: 225Lb / 102 Kg



Thank you for purchasing from DHFE!

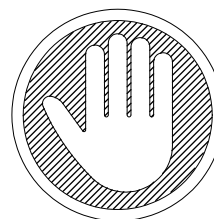

DO NOT RETURN TO THE STORE !

If parts are missing or damaged, we will gladly ship your replacement parts free of charge.

Call **01284 413 114**

Date of Purchase

Lot Number



IMPORTANT - READ CAREFULLY - RETAIN FOR FUTURE REFERENCE

N.C. - 10/30/2017

B344051419UK00- 221640

Warranty Information

DHFE warrants this product to be free from defects in material and workmanship and agrees to remedy any such defect. This warranty covers one year from the date of original purchase. This is solely limited to the repair or replacement of defective parts and assembly labor is not included.

This warranty does not apply to any product which has been improperly assembled, subjected to misuse or abuse or which has been altered or repaired in any way. Liability for consequential damages is excluded to the extent exclusion is permitted by law. This warranty gives you specific legal rights and you may also have other rights which vary from county to county.

To obtain warranty service, purchaser must present original bill of sale. Components repaired or replaced are warranted through the remainder of the original warranty period only. The defective components will be repaired or replaced without charge, subject to the terms and conditions described above.

Contact Us!

For help with assembly, identifying parts, product information or to order parts, please contact us:



01284 413 114

Monday - Friday
8:00 am - 16:30 pm
(GMT)

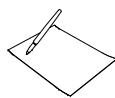

DHFE Ltd

Building 4 Imperial Place,
Maxwell Road, Borehamwood
Hertfordshire, WD6 1 United
Kingdom



support@dhfeurope.com

Read Before Beginning Assembly

- Call our Customer Care phone number if you need assistance.
- Work in a spacious area and near where the unit will be used, preferably on a carpet, or use a piece of the cardboard packaging to protect your floor and product.
- Recommended # of people needed for assembly: **2**
- Estimated assembly time is **1** hour.
- Make sure all parts are included. Most parts are labeled or stamped on the raw edge.
- Read each step carefully. It is very important that each step of the instructions is performed in the correct order. If these steps are not followed in sequence, assembly difficulties will occur.

Caution

- This product is designed for home use and not intended for commercial use.
- This product contains small components. Please ensure that they are kept away from small children.
- Do not use power tools to assemble your furniture. Power tools may strip or damage the parts.

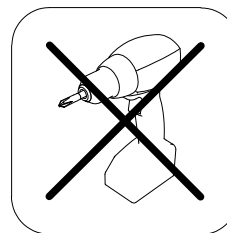

Parts

Replacement Parts, Call **01284 413 114**

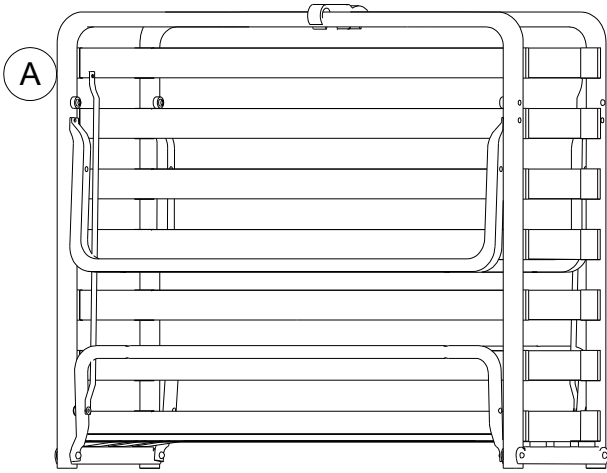

☐
Bed Frame
X 1

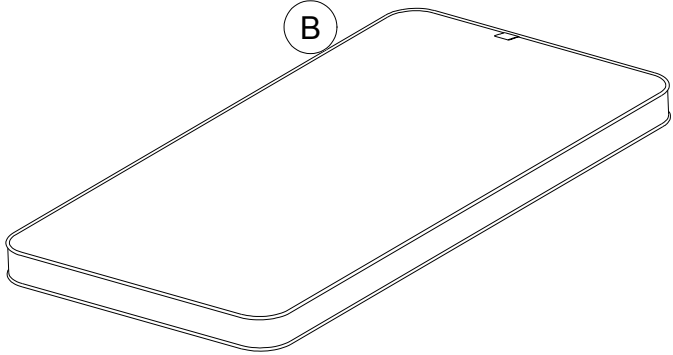

☐
Bed Mattress
X 1

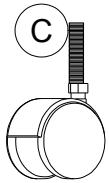

☐
Casters
UK930910
X 4

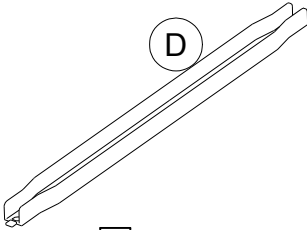

☐
Leg Cross Bar
UK930900
X 2

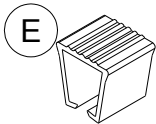

☐
Leg Cap
UK393360
X 4

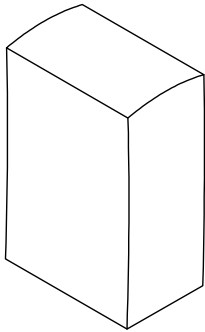

☐
Protector Cover
UK933950
X 1



This item is packed in 1 box!



Before you throw the package, please use the Check Box to identify the parts and ensure that you have all the parts needed for the assembly.

Hardware Pack

Hardware Pack #: **UK4051419-00**

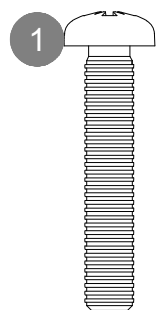

1/4" x 1 3/8"
X 2

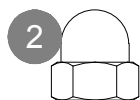

X 2

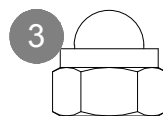

X 4

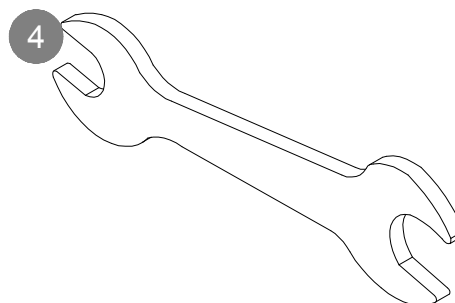

X 1



Please do not completely tighten all the hardware, until the entire assembly is complete, unless otherwise indicated in the step-by-step instructions.



The screw(s), bolt(s) to be used at each step are shown in actual size in the lower right corner of the page.

Step 1

Open Clip Lock Bar on **A**, put Mattress **B** aside and remove hardware pack. Then lock frame again with Clip Lock Bar.

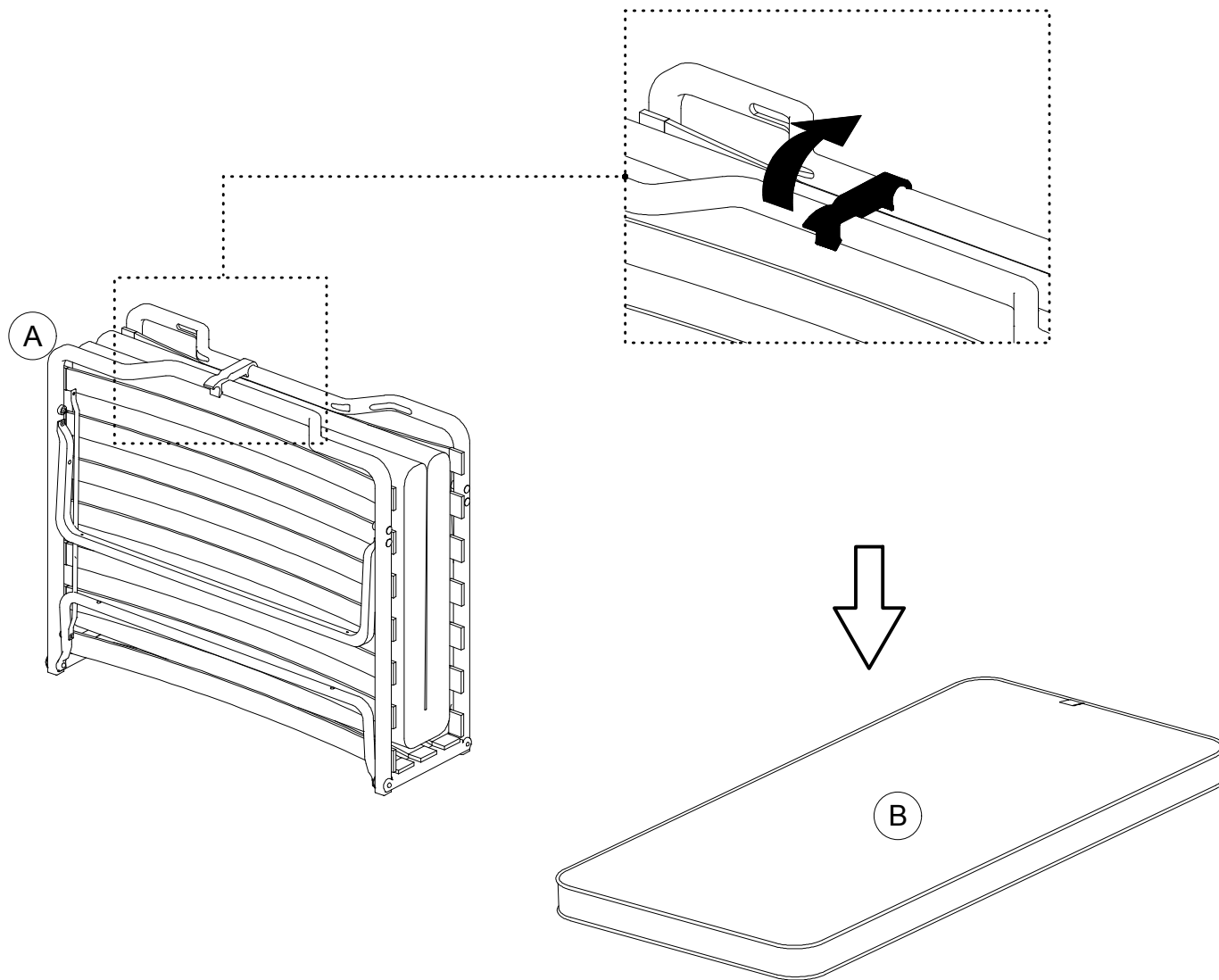

Step 2

Placed folded bed on its side and extend the two center legs as illustrated.

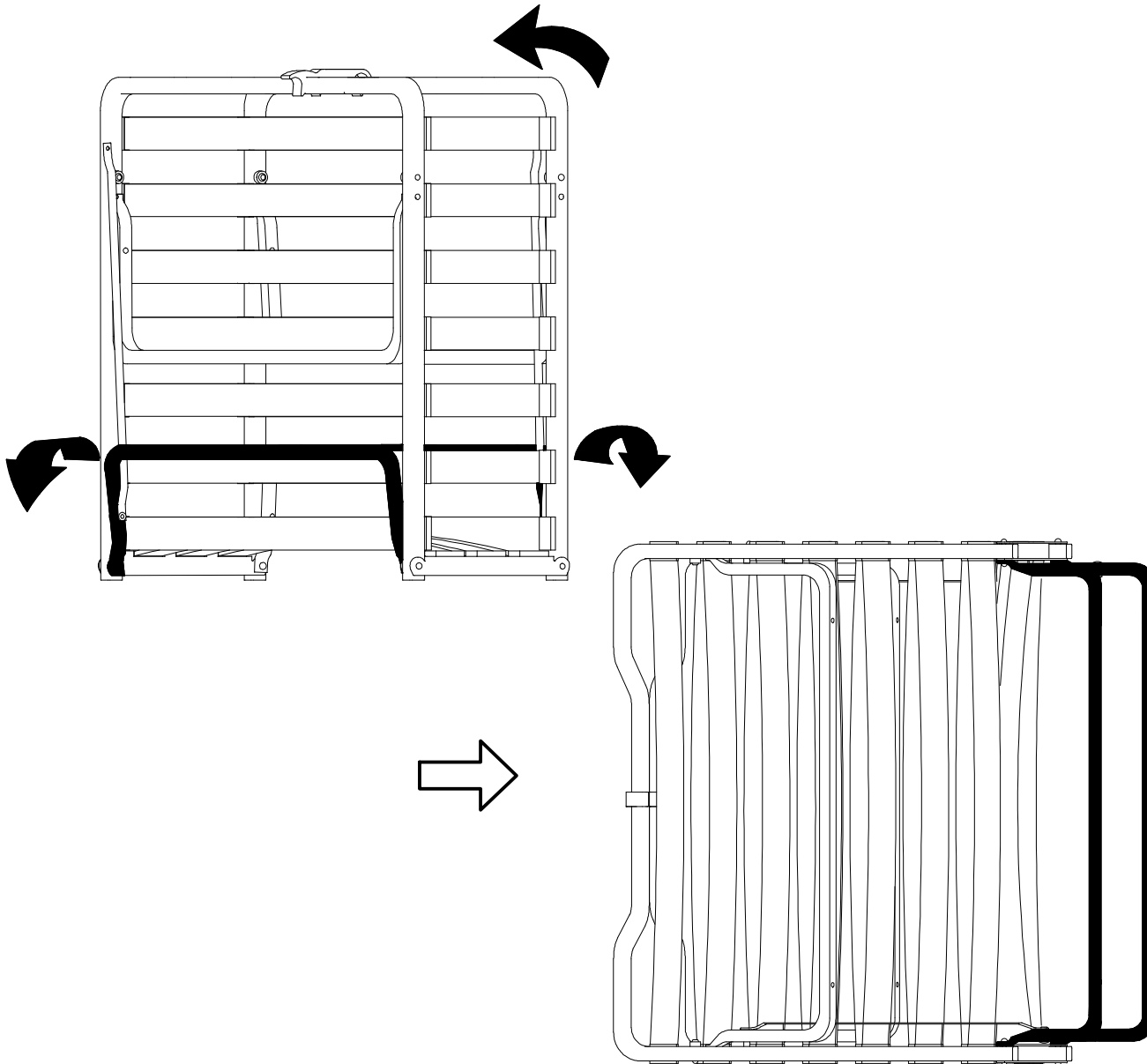

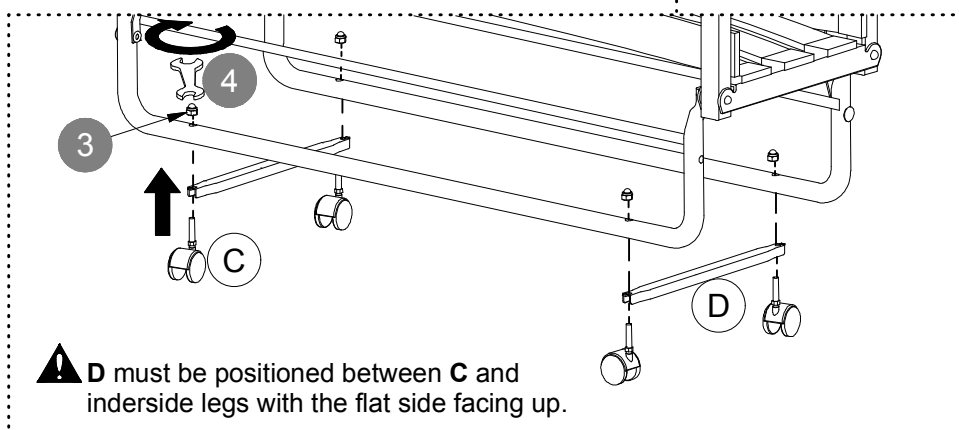
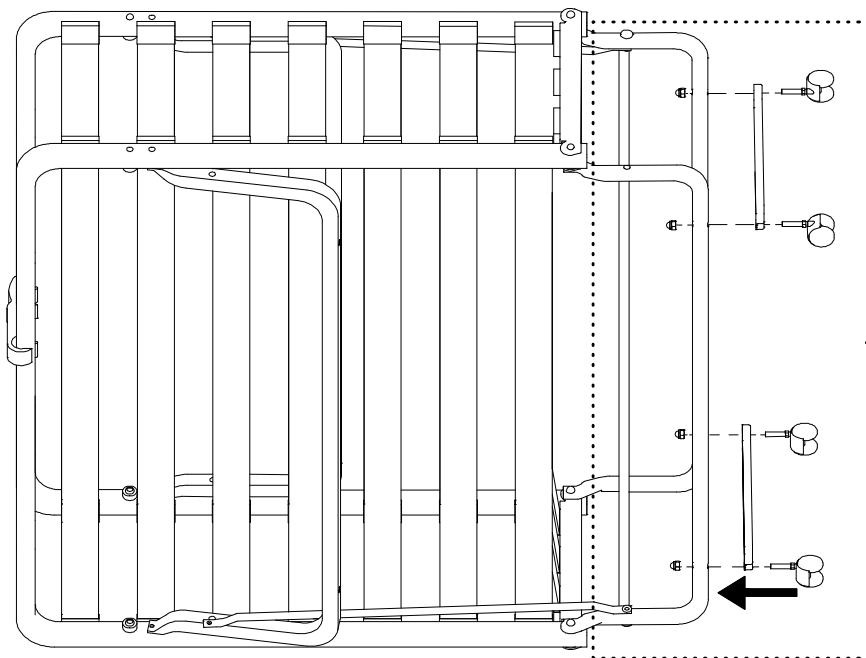

Step 3

With the bed folded on its side, place **D** X 2 across the center legs **D** aligning the holes with the inside legs, as illustrated. Then Insert **C** X 4 through **C** and **D** and secure with **3** and **4**.

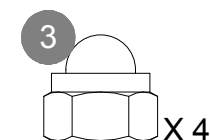

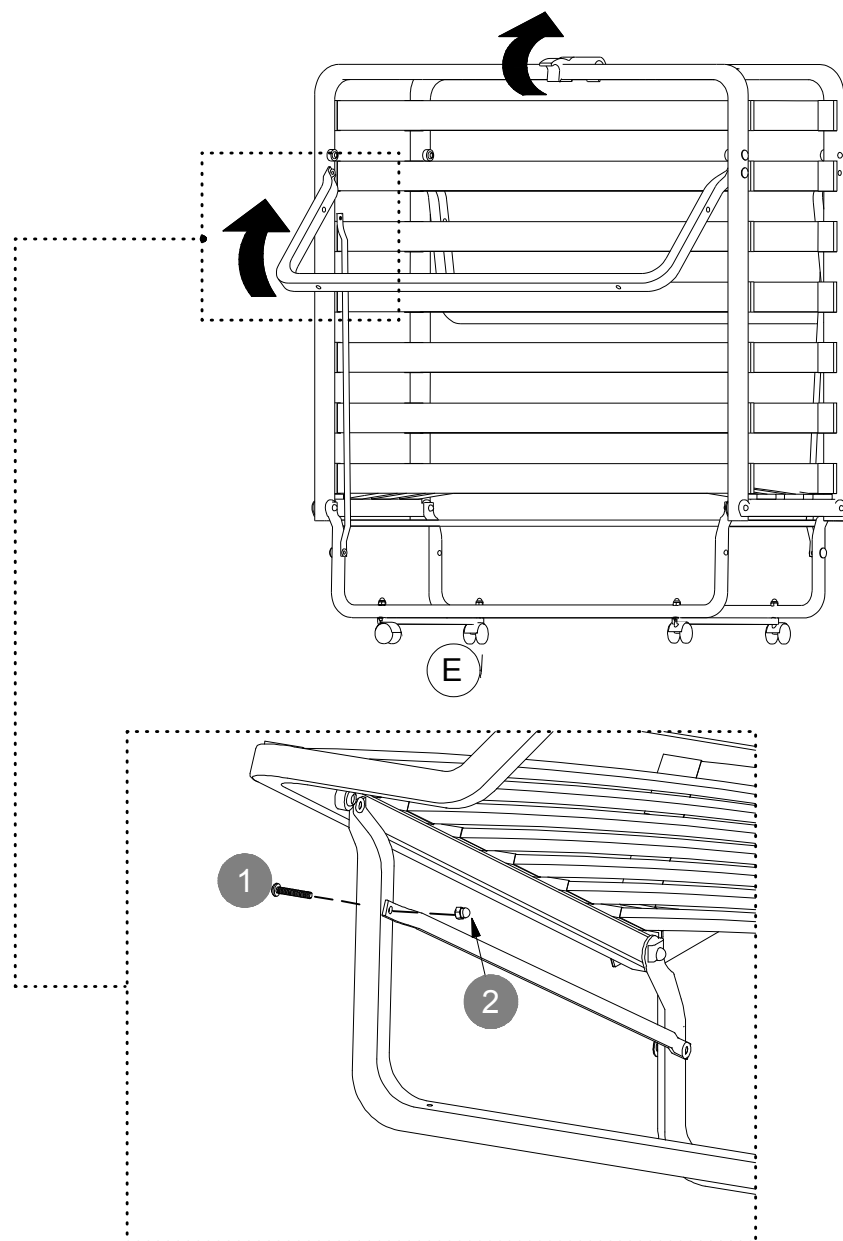

Step 4

Release snap click lock bar, carefully unfold one side of the bed until the bed retention bar hole aligns with the corresponding extended outer leg hole. Secure with ① and ②. Repeat for the opposite side.

⚠ Please note that bed must be partially unfolded for the holes to align.

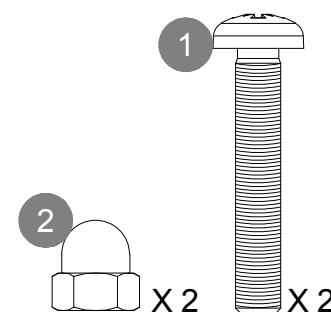

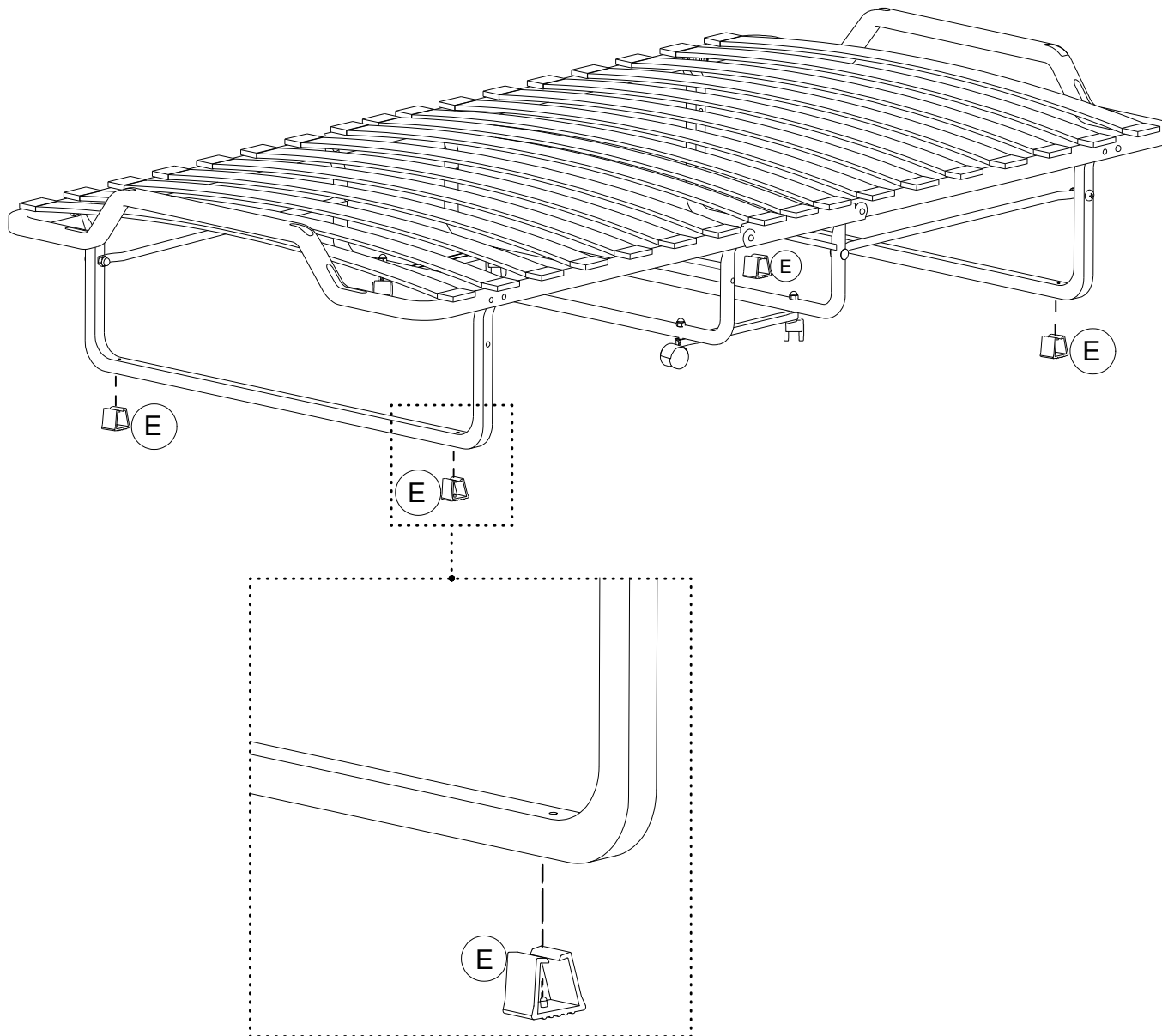

Step 5

Stand bed upright and attach **E** X 4 as shown.

 Weight Limit: 225 Lb / 102 Kg

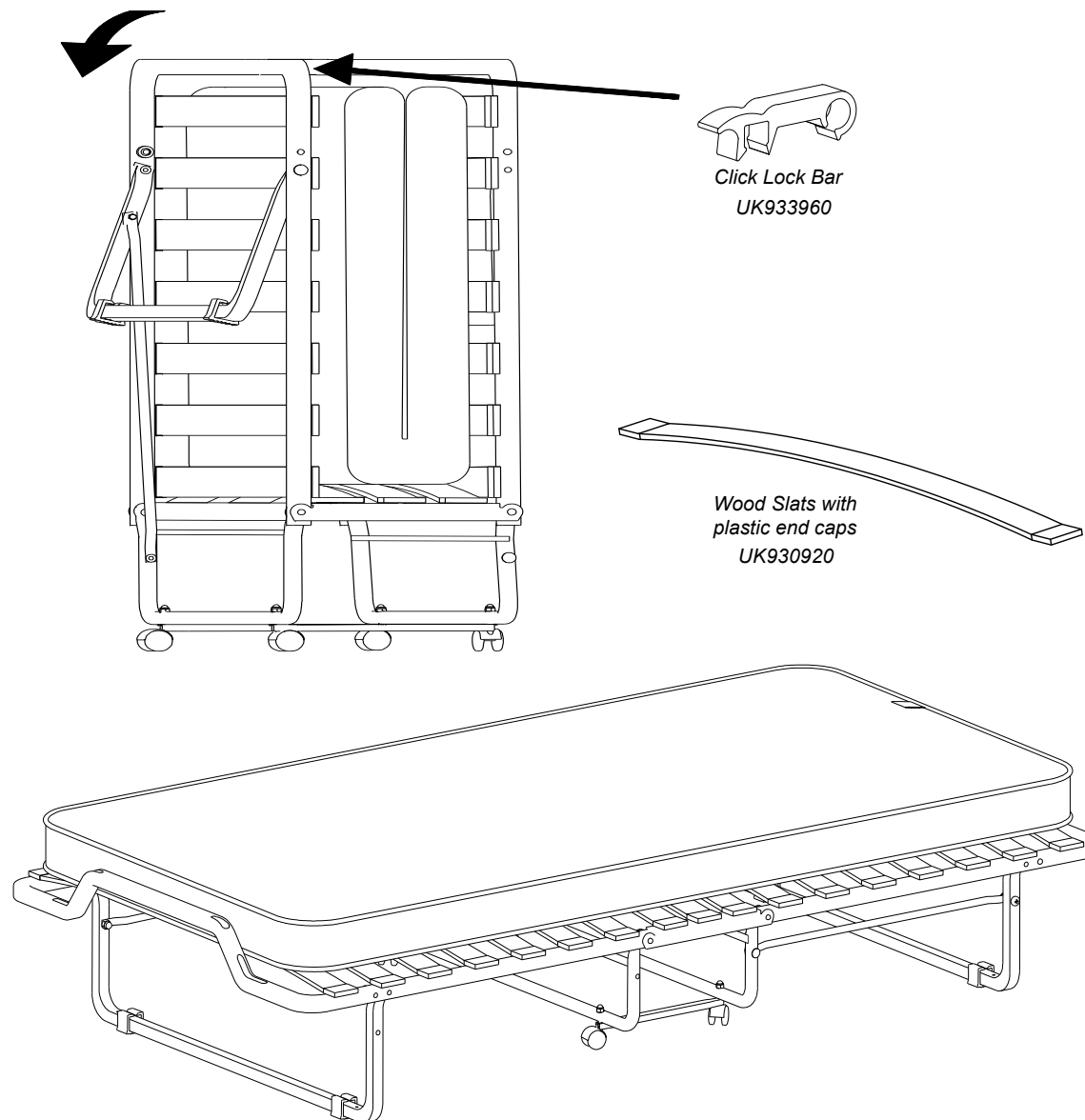

Helpful Hints

- Move your new furniture carefully, with two people lifting and carrying the unit to its new location.
- Your DHP furniture can be disassembled and reassembled to move.
- To clean, use a soft or slightly damp cloth, then wipe with a clean, dry cloth. DO NOT USE harsh chemicals or abrasive cleaners.
- Handles must be held firmly when operating to prevent bed from opening too rapidly.
- To operate bed, hold both handles firmly, release clip lock bar. Gently lower one side to the floor, repeat for opposite side.
- To close simply fold and secure with clip lock bar.
- Some parts have been pre-assembled for this item. They are illustrated on this page and available for replacement.

WARNINGS:

For safety reasons and to prevent injuries:

- This bed is not intended for use by children under 4 years old.
- Prohibit jumping and horseplay on this bed.
- Please do not place hands near hinges when operating the bed.
- Get rid of the bag and any other packaging materials immediately after removing the product. Do not reuse this bag. To avoid danger of suffocation, keep this bag away from babies and children. Do not use in cribs, beds, carriages or play pens. The thin film may cling to the nose and mouth and prevent breathing. THIS BAG IS NOT A TOY.